



# SEMINARS & CONFERENCES

**MEETINGS, "THE WAY I LIKE THEM"**

## HOTEL INFORMATION

- Number of rooms: 282  
 Comfort rooms: 178  
 Superior rooms: 79  
 Junior Suites: 10  
 Suites: 12  
 Apartments: 3
- Number of floors: 5

## EQUIPMENT

- Air conditioning, flatscreen TV, DVD/CD player, mini bar, notebook-sized room safe, telephone
- Wi-Fi internet access throughout the hotel
- 9 Seminar rooms for up to 340 persons
- 2 Meeting rooms at 5<sup>th</sup> floor with view of Vienna
- 5 Business suites
- Restaurant UNO
- U-ONE Bar
- Wellness & fitness room with view of the Vienna Skyline
- Hoteltown car park for 121 vehicles
- Direct access to the "Alte Donau" recreational area

## BASIC EQUIPMENT

- 1 Projection screen
- 1 Projector
- 1 Flip chart with pad
- 1 Pin board
- 1 Notepad with pen per person
- 1 Presenter's kit

## EQUIPMENT BUSINESS SUITE

- Meeting table for up to 12 persons
- Projector, projection screen
- Smart TV
- Wi-Fi internet access
- Telephone
- Couch
- Espresso machine
- Kitchenette, terrace in some suites

## ROOMS & SEATING



ROOM	AREA in m <sup>2</sup>	L X W in m	HEIGHT in m	BANQUET	BLOCK	RECEPTION	PARLIAMENT	CIRCLE	THEATRE	U-SHAPE
Donau	30	7,6 x 4	3,8	-	18	30	9	20	20	16
Jangtse	30	7,5 x 4,3	3,5	-	18	30	9	20	20	16
Murray	30	7,8 x 4,3	3,5	-	18	30	9	20	20	16
Wolga	70	9,1 x 7,6	3,8	40	18	60	24	30	35	16
Amazonas	70	8,9 x 7,8	3,5	40	18	60	24	30	35	18
Mississippi	70	8,9 x 7,5	3,5	40	18	60	24	30	35	18
Moldau	44	7,5 x 5,0	2,5	-	12	-	-	-	-	-
Nil	25	6,8 x 3,8	3,5	-	9	15	6	10	15	10
Vis	50	8,4 x 5,6	3,5	-	15	-	18	20	35	16
Thaya	45	5,0 x 8,0	3,0	-	12	-	20	-	20	-
Mur	18	3,0 x 6,0	2,7	-	12	-	-	9	12	-
Donau/Wolga	100	13,1 x 7,6	3,8	64	28	80	52	30	80	30
Murray/Amazonas	100	13,2 x 7,8	3,5	64	28	80	52	30	80	30
Jangtse/Mississippi	100	13,2 x 7,5	3,5	64	28	80	52	30	80	30
Donau/Wolga/Nil/Foyer	150	13,1 x 11,5	3,5	80	-	100	76	40	120	36
Murray/Amazonas/Nil/ Foyer	150	13,2 x 11,7	3,5	80	-	100	76	40	120	36
Murray/Amazonas/ Jangtse/Mississippi	200	13,2 x 15,3	3,5	96	-	130	126	60	200	44
Donau/Wolga/Nil/ Foyer/Murray/ Amazonas	250	19,3 x 13,2	3,5	144	-	180	154	80	220	50
Kaiserwassersaal	350	26,8 x 13,3	3,5-3,8	260	-	280	210	100	340	60

For further information, please see „Business & Conferences“ on our website | [arcotelhotels.com](http://arcotelhotels.com)

## GROUND FLOOR

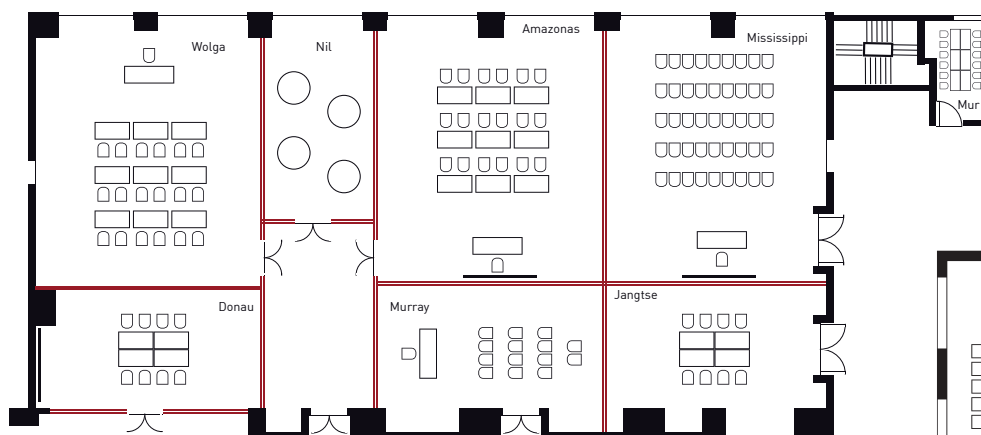

## 5TH FLOOR

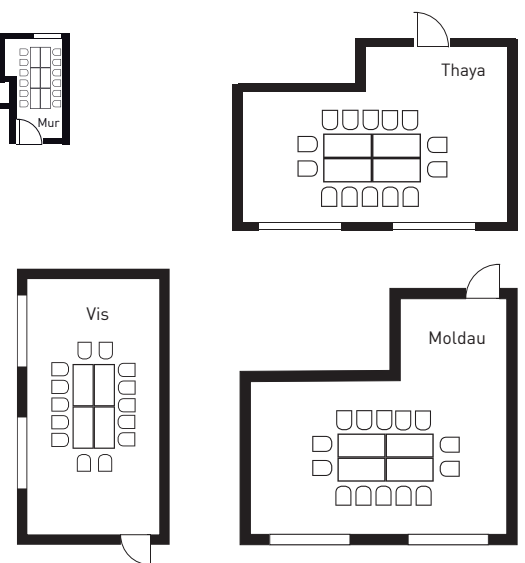

## HOW TO GET TO US



### ARRIVAL BY CAR

From the west: Exit the A1 motorway at the "Wien-Auhof" junction, continue straight on until the "Magaretengürtel", where you turn left in the direction of "Praha" up to Heiligenstädterstraße, then follow the road to the right in the direction of "Praha". Drive over Floridsdorfer bridge and switch to the A22 in the direction of "Graz/Linz/Budapest" until the "Kagran" exit.

### ARRIVAL BY TRAIN

From the Central Station (Hauptbahnhof): Take the U1 underground in the direction of Leopoldau, alighting at "Vienna International Centre/Kaisermühlen".

From the West Station: Take the U3 underground in the direction of Simmering to "Stephansplatz", switching to the U1 in the direction of Leopoldau, alighting at "Vienna International Centre/Kaisermühlen".